

Part No. WCON-29SEP-0.254

40GHz 180° 2.92mm(F) End Launch, 0.254mm (10mil) PCB Connector



Features:

- High repeatability
- Low VSWR



Electrical Specification

Frequency	DC-40GHz
VSWR	1.34:1(Max.)
Impedance	50 Ohm
Connector Type	2.92mm Female

Mechanical Specification

Durability	500Cycles
------------	-----------

Material Specification

Center Contact	Stainless Steel
Body	Beryllium Copper Plated Gold
Insulator	PTFE

Outline Drawing

Unit:mm(inch)

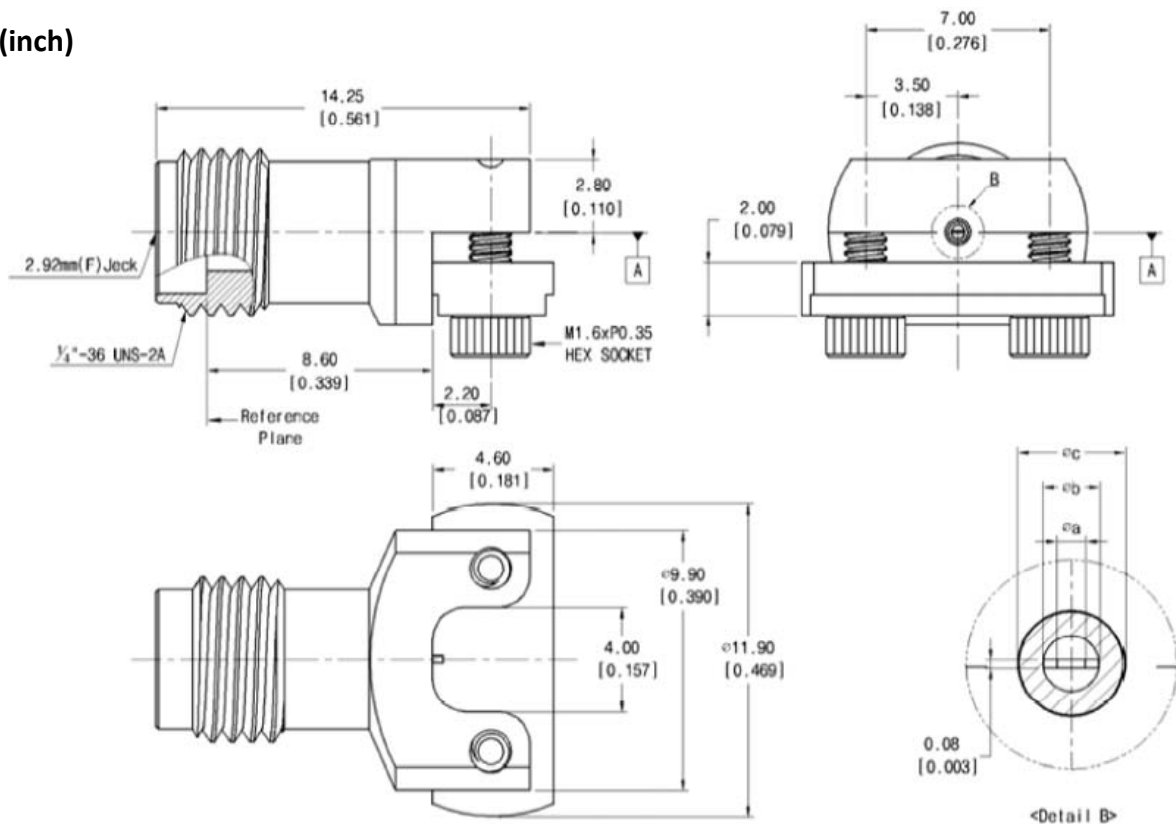

<Recommended pattern>

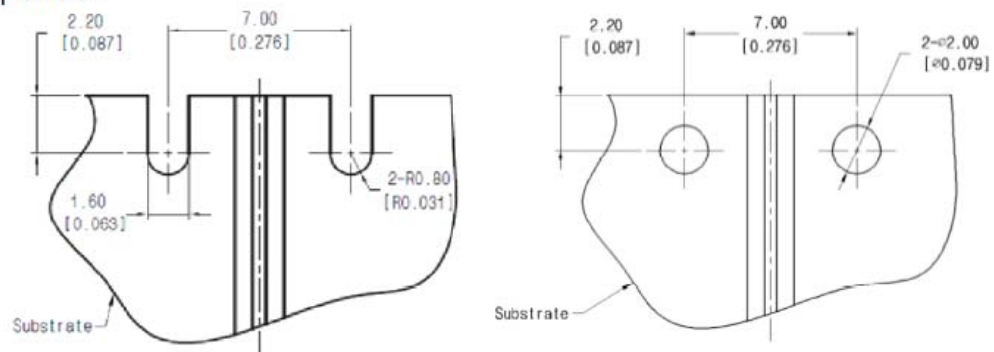

Type	PCB		Pin Diameter		Dielectric Dia.
	Substrate Thick.	Pattern Width	ϕa	ϕb	ϕc
	mil		mm		
RO4350B	10.0	0.545	0.28	0.54	1.00

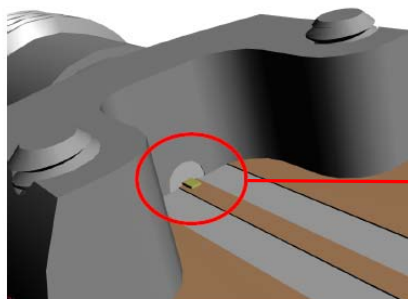

The length is 0.4mm