

## Part No. WCON-24FS2HP0.3

### 50GHz 180° 2.4mm(F) 2Hole Accept Pin 0.3mm Connector

#### Features:

- Low VSWR



#### Electrical Specification

Frequency	DC-50GHz
Impedance	50 Ohm
V.S.W.R	1.15:1(Max.)
Connector Type	2.4mm Female 2Hole

#### Mechanical Specification

Durability	500Cycles
------------	-----------

#### Material Specification

Housing	SU303F Polished & Passivated
Center Contact	Beryllium Copper Plated Gold
Insulator	PEI

#### Environmental Specification

Operating Temperature	-55~+165°C
-----------------------	------------

#### Outline Drawing

Unit:mm(inch)

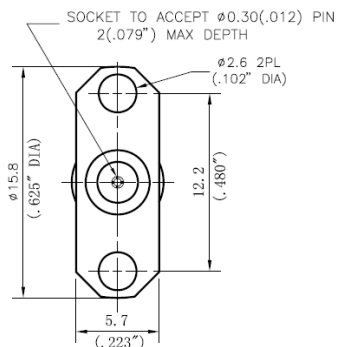
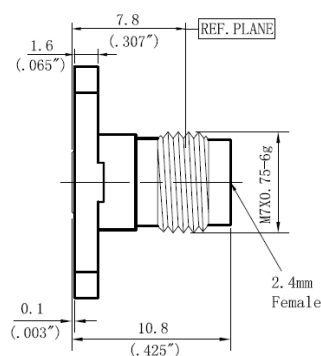

Unit:inch

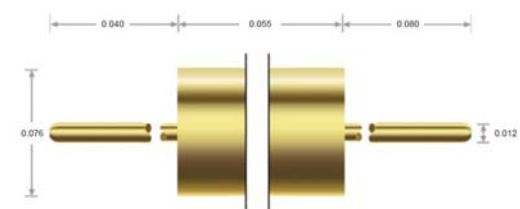

All Dimensions are in inches, the tolerance to be +/- .005"

